

North-South Cycle Superhighway (CS6) Section 1 - Farringdon Street



North - South Cycle Superhighway continues south to Elephant & Castle (in construction)

Continued on Section 2

Stonecutter Street closed for traffic.
Area impacted by another development - not part of this consultation

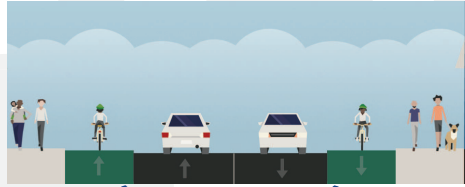
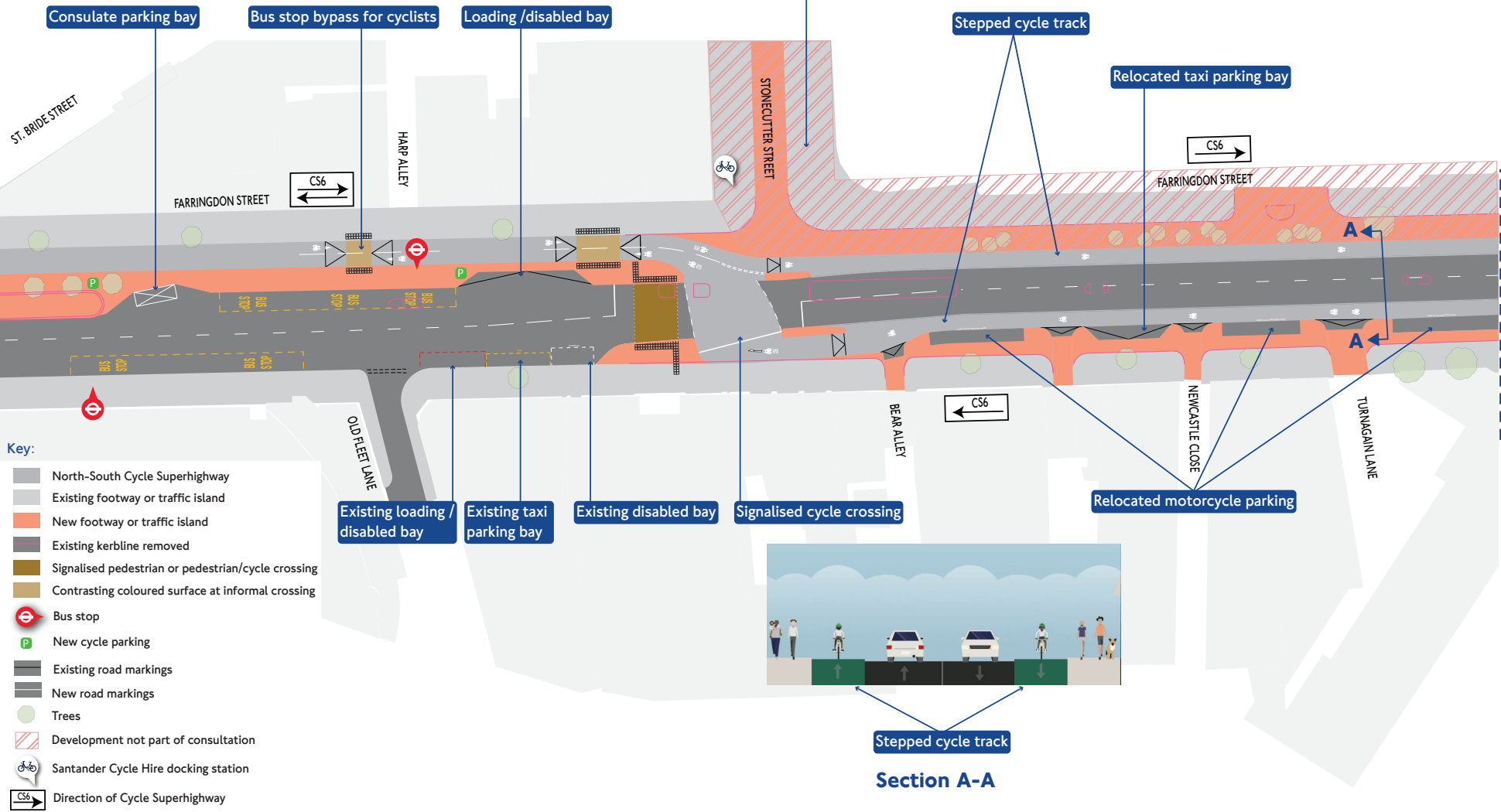

Stepped cycle track

Section A-A

- Key:**
- North-South Cycle Superhighway
 - Existing footway or traffic island
 - New footway or traffic island
 - Existing kerbline removed
 - Signalised pedestrian or pedestrian/cycle crossing
 - Contrasting coloured surface at informal crossing
 - Bus stop
 - New cycle parking
 - Existing road markings
 - New road markings
 - Trees
 - Development not part of consultation
 - Santander Cycle Hire docking station
 - Direction of Cycle Superhighway

North-South Cycle Superhighway (CS6) Section 2 - Farringdon Street

